

ROSEVILLE
REQUEST FOR COUNCIL ACTION

Date: 2-14-11

Item No.: 12.c

Department Approval

City Manager Approval



Item Description: **Community Development Department Request to Perform an Abatement for Unresolved Violations of City Code at 590 Highway 36 West.**

1 **BACKGROUND**

- 2
- 3 • The subject property is a single-family detached home.
 - 4 • The home is currently in foreclosure.
 - 5 • Current violations include:
 - 6 • Numerous house maintenance issues, outside storage of junk, debris, and brush, and an
 - 7 unlicensed vehicle in the driveway (violation of City Code Sections 407.02.J & K,
 - 8 407.02.D., 407.03.H, and 407.02.O).
 - 9 • A status update, including pictures, will be provided at the public hearing.

9 **POLICY OBJECTIVE**

10
11 Property maintenance through City abatement activities is a key tool to preserving high-quality
12 residential neighborhoods. Both Imagine Roseville 2025 and the City’s 2030 Comprehensive Plan
13 support property maintenance as a means by which to achieve neighborhood stability. The Housing
14 section of Imagine Roseville suggests that the City “implement programs to ensure safe and well-
15 maintained properties.” In addition, the Land Use chapter (Chapter 3) and the Housing and
16 Neighborhoods chapter (Chapter 6) of the Comprehensive Plan support the City’s efforts to maintain
17 livability of the City’s residential neighborhoods with specific policies related to property maintenance
18 and code compliance. Policy 6.1 of Chapter 3 states that the City should promote maintenance and
19 reinvestment in housing and Policy 2.6 of Chapter 6 guides the City to use code-compliance activities
20 as one method to prevent neighborhood decline.

21 **FINANCIAL IMPACTS**

22 City Abatement:

23 An abatement would encompass the following:

- 24
- 25 • Building maintenance – repair and paint outside staircase, window trim and doors,
26 siding, and shed:
 - 27 ○ Approximately - \$4,500.00
 - Removal of junk and debris:

28 o Approximately - \$700.00

29 • Impound vehicle:

30 o Approximately - \$0.00

31 Total: Approximately – \$5,200.00

32

33 In the short term, costs of the abatement will be paid out of the HRA budget, which has allocated
34 \$100,000 for abatement activities. The property owner will then be billed for actual and administrative
35 costs. If charges are not paid, staff is to recover costs as specified in Section 407.07B. Costs will be
36 reported to Council following the abatement.

37 **STAFF RECOMMENDATION**

38 Staff recommends that the Council direct Community Development staff to abate the above referenced
39 public nuisance violations at 590 Highway 36 W.

40 **REQUESTED COUNCIL ACTION**

41 Staff recommends that the Council direct Community Development staff to abate the public nuisance
42 violations at 590 Highway 36 W by hiring general contractors to: repair and paint outside staircase,
43 window trim and doors, siding, and shed; remove junk and debris; and impound vehicle.

44 The property owner will then be billed for actual and administrative costs. If charges are not paid, staff
45 is to recover costs as specified in Section 407.07B.

46

Prepared by: Don Munson, Permit Coordinator

Attachments: A: Map of 590 Highway 36 W

590 Highway 36

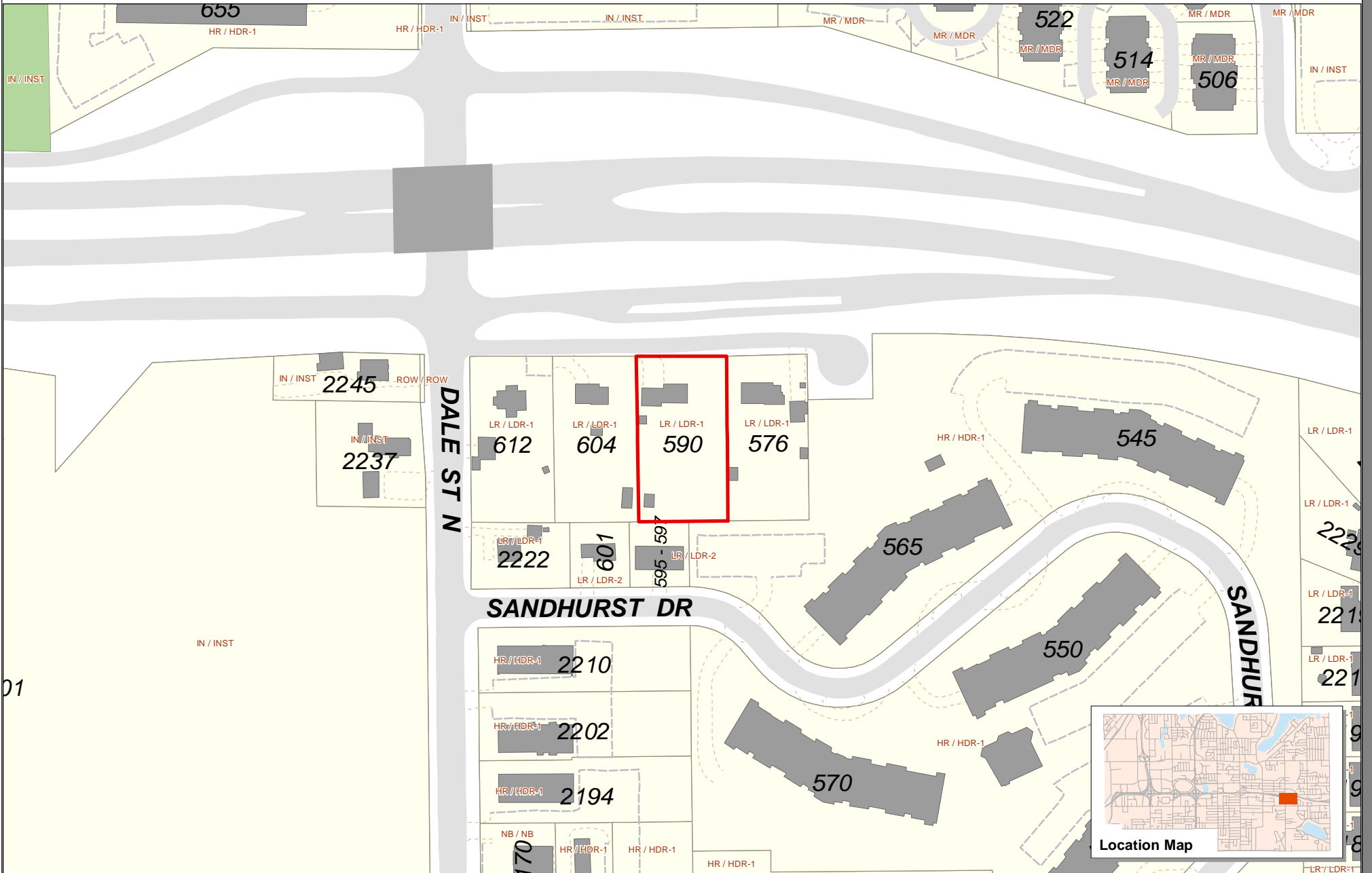

Prepared by:
Community Development Department
Printed: January 10, 2011



Site Location

LR / R1 Comp Plan / Zoning Designations

Data Sources

* Ramsey County GIS Base Map (1/3/2011)
For further information regarding the contents of this map contact:
City of Roseville, Community Development Department,
2660 Civic Center Drive, Roseville MN

Disclaimer

This map is neither a legally recorded map nor a survey and is not intended to be used as one. This map is a compilation of records, information and data located in various city, county, state and federal offices and other sources regarding the area shown, and is to be used for reference purposes only. The City does not warrant that the Geographic Information System (GIS) Data used to prepare this map are error free, and the City does not represent that the GIS Data can be used for navigational, tracking or any other purpose requiring exacting measurement of distance or direction or precision in the depiction of geographic features. If errors or discrepancies are found please contact 651-792-7085. The preceding disclaimer is provided pursuant to Minnesota Statutes §466.03, Subd. 21 (2000), and the user of this map acknowledges that the City shall not be liable for any damages, and expressly waives all claims, and agrees to defend, indemnify, and hold harmless the City from any and all claims brought by User, its employees or agents, or third parties which arise out of the user's access or use of data provided.

