

 2134 Cleveland Avenue

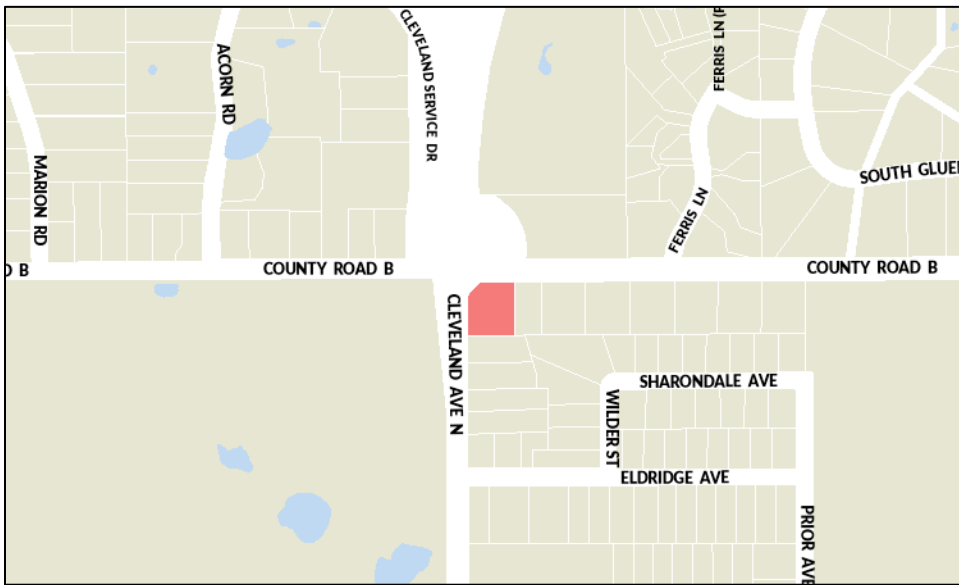

Roseville’s current comprehensive plan, the 2030 Comprehensive Plan, designates this property for residential uses. Because it was acquired in 2017 for incorporation into Roseville’s system of parks and open spaces, **the designation for this property is proposed to change to Parks & Open Space**. The current draft of the 2040 Comprehensive Plan describes the Parks & Open Space land use category as follows:

Park and open space land uses include public active and passive recreation areas such as parks, playfields, playgrounds, nature areas, and golf courses.